



GALAPAGOS
G R A N D
ODYSSEY

M/Y GALAPAGOS GRAND ODYSSEY
2013 - 2014



Our experience ensures that yours is truly memorable!



M/Y GALAPAGOS GRAND ODYSSEY INDEX

* Galapagos Grand Odyssey	1
* Photos	4
* Technical Specifications	11
* Deck Plans	12
* Itineraries	14
* The Galapagos Islands	20
* Destination we visit	30
* Activities	45
* Tips & Hints	46
* Booking Procedure	48

M/Y GALAPAGOS GRAND ODYSSEY



Our yacht will combine premium class, privacy and comfort in the marvellous setting of the Galapagos Islands. M/Y Grand Odyssey will have a capacity for 16 passengers, it features 8 spacious Galapagos & matrimonial suites (25m² aprox) and 1 Odyssey suite (35m² approx) equipped with panoramic windows to enjoy the wonderful landscapes of the islands, private bathroom, hot/cold water, air conditioning with independent controls, minibar and TV. Twin beds or one faux king bed and connected suites for families.

Local and International dishes especially designed by our chef, will be served in the cosy atmosphere of our dining room. Our yacht will offer a large solarium with shaded and uncovered areas, two Jacuzzis, comfortable sun loungers. Social areas include saloon, mini library and video library and a play zone for kids (during family departures). Snorkeling equipment and kayaks will be available without any extra charge.

M/Y GALAPAGOS GRAND ODYSSEY



The Galapagos Grand Odyssey offers avid travellers the opportunity to experience close encounters with the unique wildlife of the Galapagos Islands. We invite you to join us on board our premium class yacht and admire the wonders of evolution as you enjoy all the creature comforts of home topped off with world class service.



The best way for a traveller to make the most of their Galapagos vacation time is to cruise around the Islands and experience several visitor sites each day. We offer one of the best planned itineraries on board the best built liveaboard yacht. Our shore excursions have been crafted with care and allow passengers to see up close the Galapagos animals and how they have adapted to the harsh island conditions.

M/Y GALAPAGOS GRAND ODYSSEY



On your Galapagos vacation we also make sure that survival of the fittest is observed and not experienced... this is why we designed the M/Y Galapagos Grand Odyssey, a premium class yacht that represents a true evolution in the private yacht cruise industry. At Galapagos Grand Odyssey we put in over 100 years of combined experience in the design of our premium yacht "M/Y Galapagos Grand Odyssey". You will not find a private yacht in the Galapagos Islands that offers more space, comfort or service on a 16 passenger boat. Amenities on board include a jacuzzi, al fresco dining area, spacious sun and shade decks, combined with elegant interiors and a cabin layout that allows for picture windows that can be opened for fresh air flow.



A great Galapagos vacation itinerary that includes the main wildlife highlights what the Galapagos Islands have to offer. A variety of visitor sites including volcano hikes, Island trails, mangrove forests, turtle breeding farms, research centers, marine sites and more. A cruise on board the M/Y Galapagos Grand Odyssey will allow visitors to explore the both land animals and marine fauna of the Galapagos archipelago. Activities you can enjoy are trekking, horseback riding, snorkeling, scuba diving, beachcombing amongst others.



GALAPAGOS
G R A N D
ODYSSEY

M/Y GALAPAGOS GRAND ODYSSEY

Photos



Dinning Area



Dinning Area



GALAPAGOS
G R A N D
ODYSSEY

M/Y GALAPAGOS GRAND ODYSSEY

Photos



Galapagos Suite



Galapagos Suite



GALAPAGOS
G R A N D
ODYSSEY

M/Y GALAPAGOS GRAND ODYSSEY

Photos



Matrimonial Suite



Matrimonial Suite

M/Y GALAPAGOS GRAND ODYSSEY

Photos



Odyssey Suite



GALAPAGOS
G R A N D
ODYSSEY

M/Y GALAPAGOS GRAND ODYSSEY

Photos



Jacuzzi



Sun Deck

M/Y GALAPAGOS GRAND ODYSSEY

Photos



Sun Deck

M/Y GALAPAGOS GRAND ODYSSEY

Photos

Bathroom





GALAPAGOS
G R A N D
ODYSSEY

Technical Specifications

Class: Premium Class

Capacity: 16 Passengers

Cabins: 8

Length overall: 42 m

Beam: 9 m

Year of construction: 2011 in Guayaquil

Hull: Monohull of marine steel

Speed: 12 knots

Ship registry: Guayaquil – Ecuador

Deadweight: 450 tons

Gross Tonnage: 480 tons

Operated by: GalaOdyssey Cia. Ltda.

Fuel Capacity: 6.000 gallons

Port Registry : Guayaquil

Machinery (Engines): 2 Caterpillar 340 HP

Generators: Perkins 114 cabe A

Water maker: 2000 gallons per day

Water: 10000 gallons capacity

Radar: 1 Radar Furuno 38.4 Km, 1 Radar Furuno 57.6 Km

Navigation Equipment: 1 Satellite compass, 2 magnetic Compasses, Tracking equipment.

Communication System : Satellite phone

Radio: Several consoles HF-VHF-UHF, Nactex, Distrex and handheld units

Security equipment: Smoke detectors, sprinklers throughout the vessel, automatic CO2 tank for kitchen and engine room

Tender: Tender: 2 Zodiacs CARIBE C-18

Life Rafts: 2 Zodiacs for 10 and 25 people

Blue Prints

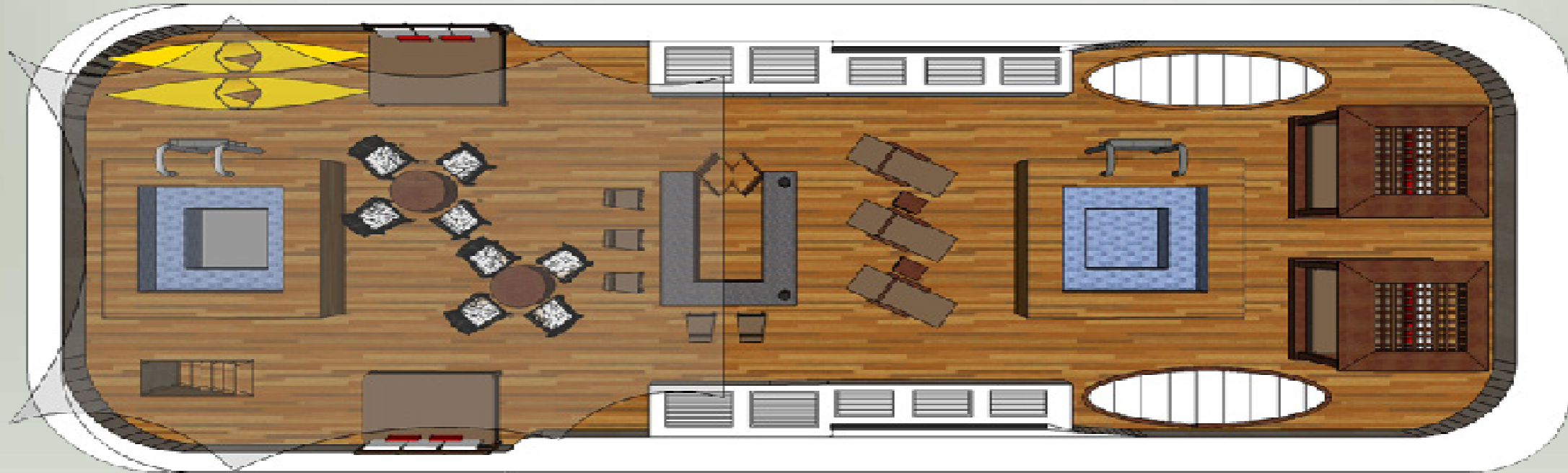

Sun Deck



Upper Deck



GALAPAGOS
G R A N D
ODYSSEY

Blue Prints



Main Deck



Lower Deck

Itineraries

ITINERARY 5 DAYS / 4 NIGHTS CRUISE - GENOVESA EXPEDITION

Sun: PM: Dragon Hill, Santa Cruz Island
 Mon: AM: Black Turtle Cove / Rabida
 PM: Chinese Hat
 Tue: AM: Prince Phillip's Steps, (Genovesa)
 PM: Darwin Bay, (Genovesa)
 Wed AM: Bartolome
 PM: Sullivan Bay, Santiago Island
 Thu: AM: Highlands, Santa Cruz Island

ITINERARY 6 DAYS / 5 NIGHTS - ESPAÑOLA EXPEDITION

Tue: PM: Cerro Colorado (San Cristobal Island)
 Wed: AM: Punta Suarez, Española Island
 PM: Gardner Bay, Española Island
 Thu: AM: Punta Cormorant / Devil's Crown, Floreana Island
 PM: Baroness Lookout / Post Office Bay, Floreana Island
 Fri: AM: Santa Fe
 PM: South Plaza
 Sat: AM: North Seymou
 PM: Bachas, Santa Cruz Island
 Sun: PM: Mosquera

ITINERARY 6 DAYS / 5 NIGHTS - FERNANDINA EXPEDITION

Thu: PM: Charles Darwin Station, Santa Cruz Island
 Fri: AM: White Tipped Reef Shark Canal, Isabela Island
 PM: Sierra Negra Volcano, Isabela Island
 Sat: AM: Punta Moreno, Isabela Island
 PM: Elizabeth Bay, Isabela Island
 Sun: AM: Punta Espinoza, Fernandina Island
 PM: Tagus Cove, Isabela Island
 Mon: AM: Espumilla Beach, Santiago Island
 PM: Puerto Egas, Santiago Island
 Tue: AM: Isla Lobos, San Cristobal



ITINERARY 10 DAYS / 9 NIGHTS - ESPAÑOLA & GENOVESA EXPEDITION

Tue: PM: Cerro Colorado (San Cristóbal)
Wed: AM: Punta Suarez, Española Island
PM: Gardner Bay, Española Island
Thu: AM: Punta Cormorant, Floreana
PM: Post office bay & Baroness Lookout, Floreana
Fri: AM: Santa Fe
PM: South Plazas
Sat: AM: North Seymour
PM: Bachas Beach, Santa Cruz Island
Sun: AM: Mosquera Islet
PM: Dragon hill, Santa Cruz Island
Mon: AM: Black Turtle Cove
PM: Chinese Hat
Tue: AM: Prince Phillip's Steps, Genovesa Island
PM: Darwin Bay, Genovesa Island
Wed: AM: Bartolomé Island
PM: Sullivan Bay, Santiago Island
Thu: AM: Highlands, Santa Cruz Island

ITINERARY 10 DAYS / 9 NIGHTS - GENOVESA & FERNANDINA EXPEDITION

Sun: PM: Dragon hill, Santa Cruz Island
Mon: AM: Black Turtle Cove
PM: Chinese hat
Tue: AM: Prince Phillip's Steps, Genovesa Island
PM: Darwin Bay, Genovesa Island
Wed: AM: Bartolomé Island
PM: Sullivan Bay, Santiago Island
Thu: AM: Highlands, Santa Cruz Island
PM: Charles Darwin Station, Santa Cruz Island
Fri: AM: White Tipped Reef Shark Canal, Isabela Island
PM: Sierra Negra Volcano, Isabela Island
Sat: AM: Punta Moreno, Isabela Island
PM: Elizabeth Bay, Isabela Island
Sun: AM: Punta Espinoza, Fernandina Island
PM: Tagus Cove, Isabela Island
Mon: AM: Espumilla Beach / Buccaneer Cove, Santiago Island
PM: Puerto Egas, Santiago Island
Tue: AM: Isla Lobos, San Cristobal

ITINERARY 11 DAYS / 10 NIGHTS - FERNANDINA & ESPAÑOLA EXPEDITION

Thu: PM: Charles Darwin Station, Santa Cruz Island
Fri: AM: White Tipped Reef Shark Canal, Isabela Island
PM: Sierra Negra Volcano, Isabela Island
Sat: AM: Punta Moreno, Isabela Island
PM: Elizabeth Bay, Isabela Island
Sun: AM: Punta Espinoza, Fernandina Island
PM: Tagus Cove, Isabela Island
Mon: AM: Espumilla Beach, Santiago Island
PM: Puerto Egas, Santiago Island
Tue: AM: Isla Lobos, San Cristobal
PM: Cerro Colorado, San Cristóbal
Wed: AM: Española Island, Gardner Bay
PM: Española Island, Punta Suarez
Thu: AM: Punta Cormorant, Floreana
PM: Post office bay & Baroness Lookout, Floreana
Fri: AM: Santa Fe
PM: Plazas
Sat: AM: North Seymour Island
PM: Bachas Beach, Santa Cruz Island
Sun: AM: Mosquera Islet



ITINERARY 15 DAYS / 14 NIGHTS - ODYSSEY EXPEDITION

Tue: PM: Baltra / Cerro Colorado (San Cristóbal)

Wed: AM: Española Island, Gardner Bay

PM: Española Island, Punta Suarez

Thu: AM: Punta Cormorant, Floreana

PM: Post office bay & Baroness Lookout, Floreana

Fri: AM: Santa Fe

PM: South Plazas

Sat: AM: North Seymour Island

PM: Bachas Beach, Santa Cruz Island

Sun: AM: Mosquera Islet

PM: Dragon hill, Santa Cruz Island

Mon: AM: Black Turtle Cove

PM: Chinese hat

Tue: AM: Prince Phillip's Steps, Genovesa Island

PM: Darwin Bay, Genovesa Island

Wed: AM: Bartolomé Island

PM: The Sullivan Bay, Santiago Island

Thu: AM: Highlands, Santa Cruz Island

PM: Charles Darwin Station, Santa Cruz Island

Fri: AM: White Tipped Reef Shark Canal, Isabela Island

PM: Sierra Negra Volcano, Isabela Island

Sat: AM: Punta Moreno, Isabela Island

PM: Elizabeth Bay, Isabela Island

Sun: AM: Punta Espinoza, Fernandina Island

PM: Tagus Cove, Isabela Island

Mon: AM: Espumilla Beach, Santiago Island

PM: Puerto Egas, Santiago Island

Tue: AM: Isla Lobos, San Cristobal

ITINERARY 15 DAYS / 14 NIGHTS - ODYSSEY EXPEDITION

- Sun: AM: Flight to Galapagos
PM: Dragon Hill, Santa Cruz Island
- Mon: AM: AM: Black Turtle Cove
PM: Chinese Hat
- Tue: AM: Prince Phillip's Steps , Genovesa Island
PM: Darwin Bay, Genovesa Island
- Wed: AM: Bartolome
PM: Sullivan Bay, Santiago Island
- Thu: AM: Highlands, Santa Cruz Island
PM: Charles Darwin Station, Santa Cruz Island
- Fri: AM: White Tipped Reef Shark Canal, Isabela Island
PM: Sierra Negra Volcano, Isabela Island
- Sat: AM: Punta Moreno, Isabela Island
PM: Elizabeth Bay, Isabela Island
- Sun: AM: Punta Espinoza, Fernandina Island
PM: Tagus Cove, Isabela Island
- Mon: AM: Espumilla Beach / Buccaneer Cove, Santiago Island
PM: Puerto Egas, Santiago Island
- Tue: AM: Isla Lobos
PM: Cerro Colorado / San Cristobal Island
- Wed: AM: Punta Suarez, Espanola Island
PM: Gardner Bay, Espanola
- Thu: AM: Punta Cormorant / Devil's Crown, Floreana Island
PM: Baroness Lookout / Post Office Bay, Floreana Island
- Fri: AM: Santa Fe
PM: South Plaza
- Sat: AM: North Seymour
PM: Bachas, Santa Cruz
- Sun: AM: Mosquera



ITINERARY 15 DAYS / 14 NIGHTS - ODYSSEY EXPEDITION

Thu: PM: Charles Darwin Station, Santa Cruz Island
Fri: AM: White Tipped Reef Shark Canal, Isabela Island
PM: Sierra Negra Volcano, Isabela Island
Sat: AM: Punta Moreno, Isabela Island
PM: Elizabeth Bay, Isabela Island
Sun: AM: Punta Espinoza, Fernandina Island
PM: Tagus Cove, Isabela Island
Mon: AM: Espumilla Beach / Buccaneer Cove, Santiago Island
PM: Puerto Egas, Santiago Island
Tue: AM: Isla Lobos, San Cristobal
PM: Cerro Colorado, San Cristóbal
Wed: AM: Punta Suarez, Española Island
PM: Gardner Bay, Española Island
Thu: AM: Punta Cormorant / Devil's Crown, Floreana Island
PM: Baroness Lookout / Post Office Bay, Floreana Island
Fri: AM: Santa Fe
PM: South Plazas

Sat: AM: North Seymour Island
PM: Bachas Beach, Santa Cruz Island
Sun: AM: Mosquera Islet
PM: Dragon hill, Santa Cruz Island
Mon: AM: Black Turtle Cove
PM: Chinese hat
Tue: AM: Prince Phillip's Steps, Genovesa Island
PM: Darwin Bay, Genovesa Island
Wed: AM: Bartolomé Island
PM: The Sullivan Bay, Santiago Island
Thu: AM: Highlands, Santa Cruz Island

M/Y GALAPAGOS GRAND ODYSSEY

The Galapagos Islands

The Galapagos archipelago is a volcanic group of islands that lie in the east Pacific Ocean. They are formed out of 19 islands, dozens of other islets and volcanic rocks and have a total land area of 3,086 square miles, spread over an area of sea covering some 20,000 square miles.

Caused by the volcanic origin the coast is rough and often dark from lava rock. The scenery is wild. There are also marvelous bays with the white sandy beaches which invite us to relax and enjoy the nature and surroundings. There is a clear contrast between the dry, hot coastal regions and the humid, chill mountain regions.



There is also the Galapagos hotspot, a place where the Earth's crust is being melted from below by a mantle plume, creating volcanoes. The oldest island is thought to have formed between 5 million and 10 million years ago. The youngest islands, Isabela and Fernandina, are still being formed, with the most recent volcanic eruption in April 2009 when lava from the volcanic island Fernandina started flowing both towards the island's shoreline and into the center caldera. The islands are geologically young and famed for their vast number of endemic species, which were studied by Charles Darwin during the voyage of the Beagle. His observations and collections contributed to the inception of Darwin's theory of evolution by natural selection.

M/Y GALAPAGOS GRAND ODYSSEY

The most famous animal on the islands is the giant tortoise. These were once numerous, but hunting has decimated their population. The tortoises are reported to live for two to three hundred years. Other reptiles include the marine iguana (the only sea going lizard in the world) and the land iguana. Birds are numerous and come in all sorts and sizes. Some of the most famous are the waved albatross, blue-footed booby, frigatebird, and penguin. Of course, the Galápagos Islands feature several species of sea lion. It is common for visitors to the Galápagos to swim with the sea lions, but care should be taken as the bulls are territorial and may be aggressive during their mating season.

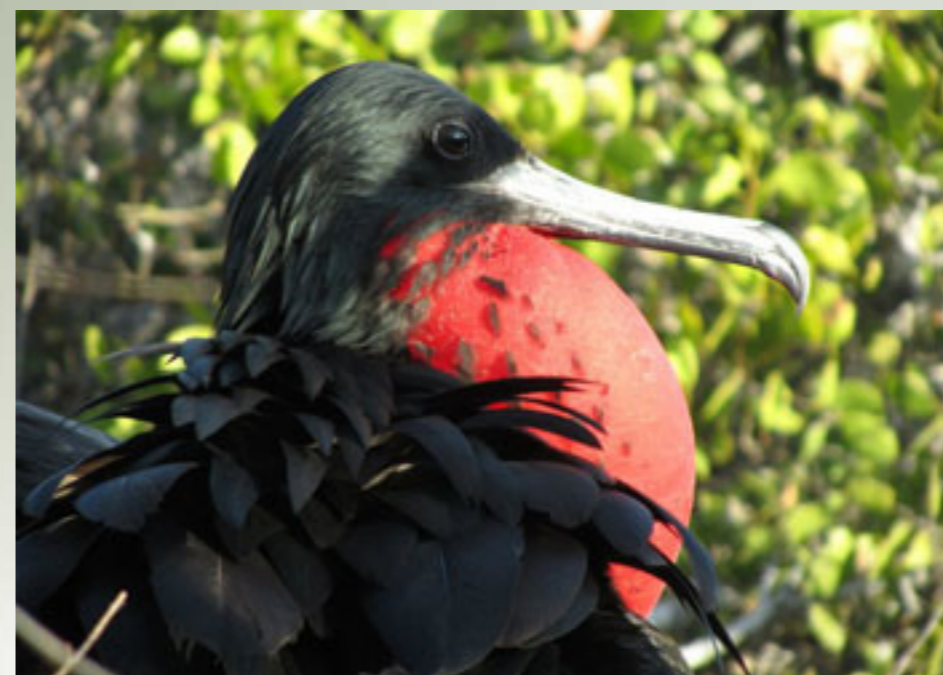

M/Y GALAPAGOS GRAND ODYSSEY

The island coasts are fringed with mangroves, sandy beaches and rocky shorelines. The plants consist of evergreens like the saltbush. Animals that live along the coast include herons, crabs, sandpipers, marine iguanas and fur seals. Further inland from the coastline lays the arid zone, where little rain falls. The vegetation in this area consists mainly of cactus, thorn trees and mesquite. Land iguanas, giant tortoises and Darwin's finches are found in this zone. The islands may also contain forest and grassy pampas zones, which are characterized by low, shrubby plants and a very moist climate.



The balanced ecosystem of the islands can be damaged easily by disturbance or by the introduction of exotic plants and animals. In the Galápagos, humans have introduced more than 150 plants, from roses to balsa trees. Many were grown in gardens, but others were left behind when commercial experiments failed. Likewise, introduced animals have seriously affected native species of plants and animals. The Charles Darwin Foundation inaugurated interest in Galápagos conservation in 1959, and all of the islands were declared a national park. In 1964, the Darwin Research Station on Santa Cruz opened. The islands now are one of the few natural areas on the World Heritage list.

M/Y GALAPAGOS GRAND ODYSSEY

The sheer number and variety of life forms both on land and in the water in the Galápagos is quite inspiring. Nearly 9,000 species call the islands and surrounding waters their home. The isolation of the Galápagos has resulted in some of the highest levels of endemism in the world. Endemic species – found nowhere else in the world – are common throughout the islands, and many are nearly unchanged since prehistoric times.



SANTA CRUZ ISLAND

Charles Darwin Research Center - Although the majority of Galapagos visitors come here to observe and appreciate the natural wonders the Islands have to offer, many also find it interesting to learn more about the protection and conservation programs in place on the islands. Some of the principal attractions of the National Park Information Center are; the Van Staelen Exhibition Hall, the Breeding and Rearing Center for young tortoises and other adult Galapagos tortoises in captivity.

Santa Cruz Highland - The trail to the highlands leaves from Belavista and passes through the agricultural zone, near the National Park boundary, the Miconia Zone and then goes to the Fern and Sedge zone. With clear weather (unpredictable) this area offers beautiful scenes of rolling hills and extinct volcanic cones covered with grass and lush greenery all year round.

Bachas Beach - Located to the West of Turtle Cove, the sand on these two small beaches is made of decomposed coral. As a result the sand here is very white and soft, making it a favorite nesting site for sea turtles. Behind one of the beaches there is a small water lagoon, where occasionally it is possible to observe flamingos and other coastal birds, such as black-necked stilts and whimbrels. The other beach is longer and has two old barges that were abandoned during the Second World War, when the USA used Baltra Island as a strategic military point in order to protect the Panama Channel. (The metal is rusty and sharp, so it is not a good place for swimming).



PLAZA ISLAND

These are two small islets that were formed a short distance from the East Coast of Santa Cruz. Despite its small size, some of the most interesting and outstanding species of the archipelago occur here. The principal attractions of Plazas are the land iguanas, sea lions and swallow-tailed gulls. It is possible to observe land iguanas relaxing in the shade of cactus plants and swallow-tailed gulls nesting on the rugged southern cliffs (which we will see along with various other sea birds). And that's not all as the protected rocky seashore is a prime habitat for a large colony of noisy sea lions. Also we will be able to see yellow – tailed mullets, Audubon's shearwaters, red-billed tropicbirds, frigate birds and brown pelicans gliding past the cliffs.

SAN CRISTOBAL ISLAND

Interpretation Center - built with the cooperation of the Spanish Science Centre, the interpretation centre gives a very good introduction to the Galapagos Islands; its marine and land life and fauna and flora. It is located in the outskirts of the small city of Puerto Baquerizo Moreno, (the capital of the Galapagos Province).

Tijeretas Hill - The trip to Tijeretas Hill takes approximately 20-40 minutes. Once there, visitors are treated to a spectacular view of the white beaches on one side and the roofs of Puerto Baquerizo on the other. The hill is named after the frigate birds that frequent the area. Here you will be able to see both the magnificent frigate birds and great frigate birds in the same colony so this is the perfect place to compare and learn to distinguish them.



ISLA LOBOS – SEA LION ISLET

This small islet, located only an hour by boat from Puerto Baquerizo Moreno, is separated from the main island by a narrow stretch of calm water. Upon its rocky shores blue-footed boobies nest and sea lions rest. The atmosphere is one of tranquillity and primitive beauty and reveals a very typical Galapagos environment.



FLOREANA ISLAND

Cormorant Point - This site offers one of the largest and best flamingo lagoons in the Galapagos. It is situated between two tuff cones, giving the area its special atmosphere. Aside from the flamingos, various species of shorebirds can be seen with the most common being stilts, white-checked pintail ducks and other migratory birds. This is a unique zone due to the huge amount of endemic plant life. It is also very interesting to observe the two distinct beaches: the “green sand beach” (due to high percentage of olivine crystals in the sand) and the “flour sand beach” made up of coral.



Post Office Bay - This site is home to a wooden barrel, historically placed there in the 18th century by the crew of a whaling ship. Ever since this time the barrel has been used by mariners and tourists as a sort of postal service. Whalers and Galapagos residents used to leave their mail inside it, waiting for the captain of any boat headed to where the mail was addressed to deliver it... why not try it out to see if it still works? What’s more, apart from being the location of the Post Office Barrel, this site was also the landing area for some of the first colonists to the Galapagos Islands. You can often snorkel with turtles from here, or visit the lava tube inland.

ESPAÑOLA ISLAND

Gardner Bay - Located on the north-eastern coast of Hood, Gardner Bay is an excellent beach for relaxing, swimming and observing sea lions. Here we will also have the opportunity to observe sharks in the crystal-clear ocean waters.

Punta Suarez - This rocky land-point sustains one of the most impressive and varied colonies of sea birds in the Galápagos. Along its southern shore, high cliffs rise up from the sea allowing the visitor spectacular views of soaring birds and of the blow hole, a lava tube where water can spout up to 75 feet into the air according to the intensity of the surf.



BARTOLOME ISLAND

A small barren island that is located across from Sullivan Bay off James Island, Bartolome has two main visitors' sites. The first site offers the possibility to climb to the summit of the island, from where visitors can observe a variety of volcanic formations including lava bombs spatter and cinder cones, lava flows and lava tubes. The moon like landscape provides one of the most scenic panoramas in the archipelago.

At the second site, visitors have the chance to relax on a beautiful beach, which offers great snorkeling opportunities. Multi-coloured fish and occasionally penguins and sea turtles have been seen at the base of the tall pinnacle rock, which dominates Bartolome's landscape. A short walk across to Bartolome's second beach and swimming is strictly prohibited. Here visitors can see white-tipped reef sharks at a safe distance swimming along the shoreline.



SANTIAGO ISLAND

Chinese hat (sombbrero chino) - is a tiny island just off the south-eastern tip of Santiago Island and is less than a quarter of 1 sq km in size. It is a recently-formed volcanic cone and its descriptive name accounts for the fact that it appears to take the shape of a downward-facing Chinese hat. (The hat shape is best appreciated from the north side.) Opposite Sombrero Chino, on the rocky shoreline of nearby Santiago Island, Galapagos penguins and eagle rays are often seen. The island is home to a large sea lion colony and plenty of marine iguanas who cover the volcanic landscape. There are some excellent snorkeling opportunities in the cove.



Puerto Egas - The excursion to Puerto Egas with its black sand beaches leads to one of the more rewarding visits of the Galapagos. The island was the site of a small salt mining industry in the 1960s, one of several unsuccessful attempts to commercialize the Galapagos. A hike inland to the salt crater is an excellent opportunity to see land birds such as finches, doves and hawks. A walk along the rugged shoreline, especially at low tide, will allow us to observe many marine species as iguanas bask on the rocks and sea lions laze in the tide pools. At the end of the trail there is a series of grottoes or sea caves where fur seals and night herons are regularly found resting on the shady ledges. For many, this is the only opportunity to see the Galapagos fur seal, once thought to be on the verge of extinction.



Sullivan Bay - This visitor site provides a unique opportunity to view lava flow that is approximately 100 years old. The Sullivan Bay Lava is known as Panoehoe (Hawaiian for rope) due to the lava flow having solidified in a mostly ropey-like appearance; it is rare to the rest of the world but is common to the volcanoes of Hawaii and Galapagos. Only a few plants have managed to take root in this harsh environment. The low-lying mollugo is commonly the first plant to emerge from a bare lava field. Together with the lava cactus (brachycereus) found here, these plants are evidence of life returning to Sullivan Bay.



Destinations we visit

Santa Cruz Island

Highlands

The route from Puerto Baquerizo follows the signs marked for El Progreso. This small town was established as a penal colony in 1888 by Manuel Cobos. The prisoners were treated as slaves and developed a sugar cane and coffee plantation. The steep road narrows as it climbs the sides of the extinct volcano. At the summit visitors are treated to a spectacular view of the El Junco Lagoon. Rainwater and condensation have collected in the caldera for hundreds of years creating this haven for frigatebirds. The lake supplies water both for the people of the island and for many of the tourist boats. Hiking around the lake offers views of practically the entire island including San Joaquin Hill the island's highest point.

Bachas Beach

These two small beaches are found to the West of Turtle Cove. Their sand is made of decomposed coral, which makes it white and soft, making it a favorite nesting site for sea turtles. Behind one of the beaches there is a small brackish water lagoon, where occasionally is possible to observe flamingos and other coastal birds, such as black-necked stilts and whimbrels. The other beach is longer, but it has two old barges that were abandoned during the Second World War, when the USA used Baltra Island as a strategically point to protect the Panama Channel.



Charles Darwin Station Although the great majority of Galapagos visitors come here to observe and appreciate natural wonders, it is also interesting to learn how the protection and conservation of the islands are carried out. One of the main attractions are the National Park information center, the Van Straelen Exhibition Hall, the Breeding and Rearing Center for young tortoises and adult Galapagos tortoises in captivity.



The Gemelos (Twin Craters)

The Gemelos are a pair of craters approximately 30 meters deep located on either side of the road to Baltra (island where the airport lies). The holes could be created because of a volcanic explosion or because of magma chambers inside earth. A good place to see the Galapagos hawk and barn owl is on this island. The surrounding forest is full of birds such as the vermilion flycatcher or the yellow warbler. The highlands and settlement area of Santa Cruz are worth seeing for the contrast of the vegetation with the arid coastal zones.



Seymour – North Seymour

Is an uplifted (as opposed to volcanic) island and so is generally flat and strewn with boulders. There are good nesting sites here for a large population of magnificent frigate birds. Blue-footed boobies perform their courtship dance in the more open areas and swallow-tailed gulls perch on the cliff edges. Despite the tremendous surf that can pound the outer shore, sea lions haul out onto the beach and can be found bodysurfing.

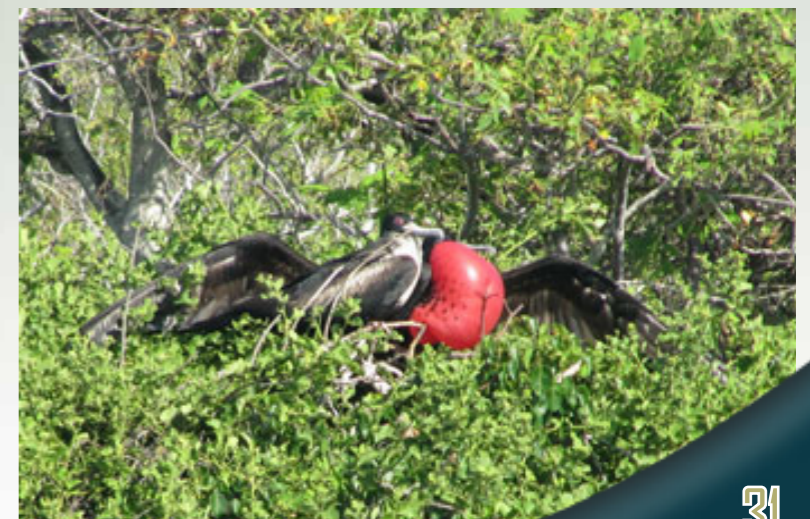

Plazas

Plazas is located at the east of Santa Cruz Island and forms part of two islands known as Islas Plazas. Despite its small size, some of the most interesting and outstanding species of the Galapagos are found here. The Plazas land iguanas are smaller than its relatives found on other islands. Throughout the island are several hybrid iguanas, a result of crossing a male marine iguana and a female land iguana. They are recognizable at first glance by their black/gray color and a land iguana's crest but with face and tail of the marine iguana. The big population of iguanas is due to the presence of tunas, their favorite food. Swallow tailed gulls nesting in the rugged cliffs are seen along with other sea birds as: Audubon shearwaters, red-billed tropicbirds, frigatebirds and brown pelicans.



Santa Fe

Santa Fe is located in the southeastern part of the Galapagos. This island was formed from uplift instead of a volcanic origin and this is why it is mostly flat. There are some theories which assure us this could be the oldest island in the Archipelago. Santa Fe is the home of a number of endemic species like the Galapagos hawk, Galapagos snake, Galapagos mockingbird, rice rats and one of the two species of land iguanas of the islands. After disembarkation in the beautiful and clear waters you will be in contact with one of the many sea lion colonies. Along the trail many salt bushes can be seen as well giant prickly pear cactus, gigantism is a characteristic of oceanic islands. There are many possibilities of snorkeling with playful sea lions and tropical fish.



Genovesa Island

Darwin Bay

This bay has its origin in when the crater of the island collapsed below sea level. The wet landing is on a beautiful white coral sandy beach. This is a favorite island for birdwatchers: red footed-booby, masked boobies, wandering tattlers, lava gulls, whimbrels, yellow-crowned and black-crowned lava herons and yellow warblers can be seen in the area.

Continuing on the trail, visitors climb gradually to the edge of the cliff seeing red-footed boobies nesting in the mangrove trees below. Bird watching includes sightings of sharp-beaked finches, large cactus and ground finches, Galapagos doves and swallow-tailed gulls. Reaching the end the trail at the cliff's edge offers an incredible view of the island and the many birds living there.



El Barranco

The visitor site of El Barranco is located in the southern part of Darwin Bay on Genovesa Island. The trail is on volcanic rock that has a length of 1.5 km and the tour can be done in about 2 hours. The youngest area of the island, from a geological point of view, lies in this area. The cliffs located in the south are composed of very fragile lava. The natural erosion that has occurred in these lava flows has become the ideal place for nesting storm petrels. You can see two species of petrels that nest in cavities and holes in the lava. One of its main predators is the short-eared owl. The red-footed booby nests only in the outer islands of the archipelago, Punta Pitt, Gardner (Floreana), Wolf, Darwin and Genovesa. Also present on this island is the masked booby. During the panga rides along the cliffs fur sea lions can be seen and several species of seabirds

Santiago Island

Puerto Egas

The excursion to Puerto Egas with its black sand beaches leads to one of the more rewarding visits of the Galapagos. The island was the site of a small salt mining industry in the 1960s, one of several unsuccessful attempts to commercialize the Galapagos. A hike inland to the salt crater is an excellent opportunity to see land birds such as finches, doves and hawks. A walk along the rugged shoreline, especially at low tide, will allow us to observe many marine species as iguanas bask on the rocks and sea lions laze in the tide pools. At the end of the trail there is a series of grottoes or sea caves where fur seals and night herons are regularly found resting on the shady ledges. For many, this is the only opportunity to see the Galapagos fur seal, once thought to be on the verge of extinction.

Chinese hat

This is a small islet (1 sq km) located just off the southeastern tip of Santiago Island. It is a recent volcanic cone, shaped like a Chinese hat when seen from north side. On the west you can see lava formations, formed under the sea and raised upward, this is why coral heads are found on the lava. This is an excellent visit for interpretation of geological features such as lava tubes and lava flows. The landscape is covered by sea lions colonies, marine iguanas, and Galapagos penguins.



San Cristobal

Pitt Point

This place is on the north of San Cristobal. Here there are endemic species such as lava lizards and red-footed boobies. The view is impressive when you walk up to the high part of the island.

You may be lucky to see the red footed booby - the least seen of the bunch. It's also the home of the Chatham mockingbird, only found here on San Cristobal island.

Kicker Rock (Leon Dormido)

Also known as the Sleeping Lion because of its resemblance, it is located on the coast of San Cristobal. The remains of a lava cone eroded by the sea, the two vertical rocks rising 500 feet from the ocean form a small channel that is navigable by small boats. This Galapagos Islands natural monument has become a favorite sight for cruises due to the many tropical birds, frigates and boobies that fill the surrounding air.

Beneath the sea the nearly crystal waters offer a brilliant show of colorful tropical fish and invertebrates.



Lobos Island

Isla Lobos is about an hour by boat from Port Baquerizo Moreno. The length of the trail is 850 meters and the estimated travel time is one hour. There is a small population of blue-footed boobies and common frigate birds nesting on this site. You can also observe the two species of sea lions present in the archipelago. During the tour you go through a dry vegetation zone, substrate of volcanic rocks and a sandy area. During the panga tour, brown pelicans and several species of shorebirds can be observed; although while snorkeling it's common to see juvenile sea lions, manta rays and sea turtles.



Interpretation Center

The Interpretation Center's lush gardens and sweeping ocean views are a strong contrast to the 1960's style buildings at the Charles Darwin Center. Visitors to the Interpretation Center can learn about both the geological and human history of the islands, conservation issues and natural history. The older Museum of Natural History attempts to preserve the natural history of the islands.



Tijeritas Hill

The trip to Tijeretas Hill takes approximately 20-40 minutes. Once there visitors are treated to a spectacular view of the white beaches on one side and the roofs of Puerto Baquerizo on the other. The hill is named after the frigate birds who frequent the area. Here you will be able to see both the magnificent frigate birds and great frigate birds in the same colony so this is the perfect place to compare and learn to distinguish them.



La Loberia

This small islet, located only an hour by boat from Puerto Baquerizo Moreno is separated from the main Island by a narrow stretch of calm water. Upon its rocky shores blue-footed boobies nest and sea lions rest. The atmosphere is one of tranquility and primitive beauty and reveals a very typical Galapagos environment.

Española

Punta Suarez

This rocky land spot sustains one of the most impressive and varied colonies of sea birds in the Galapagos. Along its southern shore, high cliffs rise up from the sea affording the visitor spectacular views of soaring birds and of the blow hole where water spouts up to 50-75 feet into the air according to the intensity of the surf.

Gardner Bay

Located on the north-eastern coast of Hood, Gardner Bay provides an excellent beach for relaxing, swimming, snorkeling, kayaking and the opportunity to observe sea lions. Here we can also observe sharks in the crystal clear ocean waters.

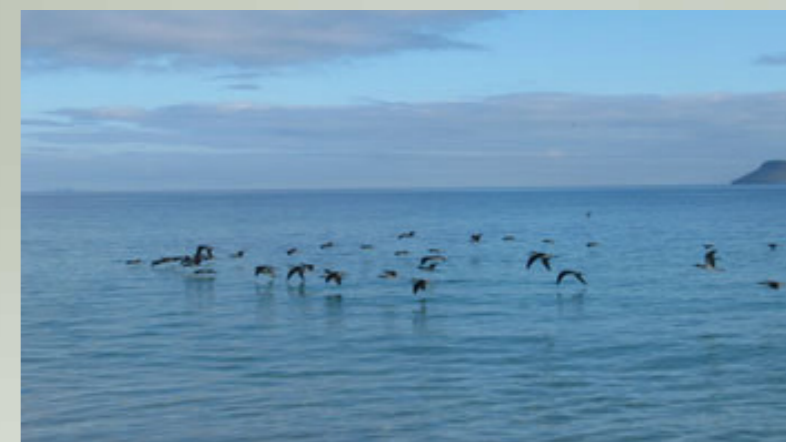

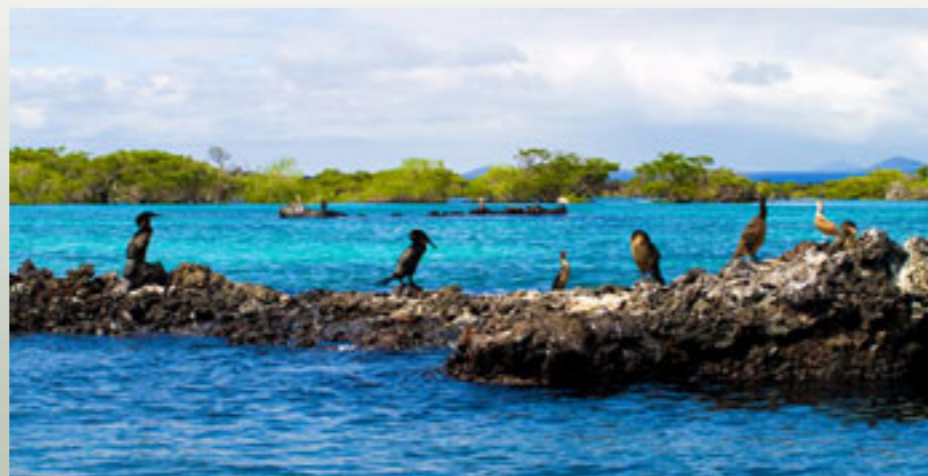

Floreana

Cormorant Point

This site offers probably the best flamingo lagoon in the Galapagos; it is also one of the largest in the islands. It's situated between two tuff lava cones that give the area a special atmosphere. There are various species of shore-birds to observe besides flamingos; the most frequent are common stilts, white-checked pintail ducks and other migratory birds. It is very interesting to see the two distinct beaches: "The Green Beach" (due to its high percentage of olivine crystals in the sand) and the "Flour Sand Beach" which is made up of coral.

Devil's Crown

The Devil's Crown, located just off Punta Cormorant, offers some of the best snorkeling in the Galapagos. In fact, the only way to see the Crown is by water; it is termed a Marine Visitor Site and no landings are allowed. Sometimes referred to as Onslow Island, this is an almost completely submerged volcano and erosion has transformed the cone into a series of jagged peaks; as a result, this site really does look like a devil's crown.

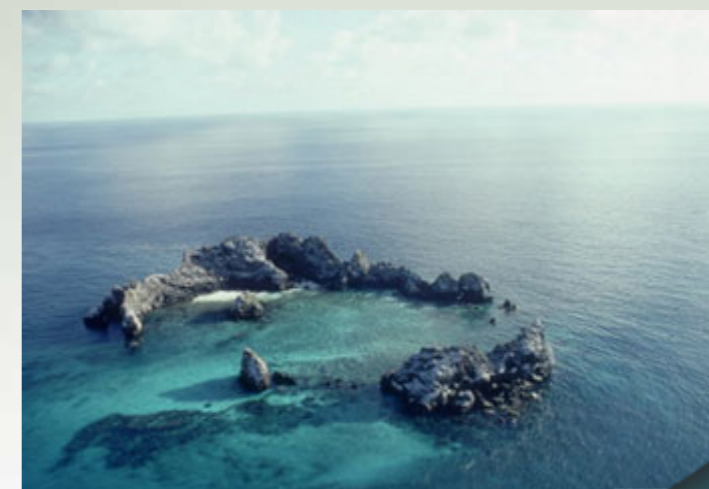

Post office bay & Baroness Lookout

Historically, this site is the location of a wooden barrel that was placed in the 18th century by the crew of a whaling ship. It has been used since this time by mariners and tourists as a post office. The idea is to carry letters or postcards to their destination by hand. Apart from being the Post Office Barrel, this site was the landing area for some of the first colonists. We will continue to the north of the island and will ascend to an elevated slope to enjoy a beautiful vista at the Baroness lookout. It is said that Baroness Eloisa Von Wagner loved this place and spent several hours watching the horizon. Within walking distance (30 m) are the ruins of what is known as her house. From this lookout, the landscape covers the coastline from the Enderby islet to Post Office Bay, as well as Cerro Pajas, the pool of flamingos and wide forest of Palo Santo.



Isabela Island

White Tipped Reef Shark Canal

A delightful place reached by a nice zodiac ride. “Tintoreras” are small islands in front of Puerto Villamil coast. There is heron lava on the lookout at mangrove branch and Galapagos penguin and sea lion often pop out on shore. White-tipped reef sharks are fairly common in the archipelago. Their name in Spanish is tintorera, therefore the name of this site is named after them as they are always found here resting in the shallow waters.



Wall of Tears

The Wall of Tears is a historic site in Isabela. Between 1946 and 1959 Isabela was a penal colony, where prisoners built a wall with huge blocks of lava as punishment. The wall is 100 meters long and 7 meters high. Due to the arduous labor and harsh conditions in which the prisoners lived, this site is known as the wall of tears. A set of stairs provides a bird's eye view of the wall and the surrounding landscape. You can still see the cement foundations of the USA base dating back to the Second World War.



Sierra Negra Volcano.

Isabela Island is the largest and one of the youngest islands in the Galapagos archipelago. We land in Puerto Villamil, which has the second smallest populated island in Galapagos with approximately 3,000 inhabitants. We head up to the highlands from Puerto Villamil to Sierra Negra slope and later we will do some hiking on uneven terrain until we arrive to the Sierra Negra volcano rim. Sierra Negra is the second widest crater in the world. From this viewpoint, you have fantastic sights to the 6 x 5 mile wide crater, the rest of the volcanoes and Perry Isthmus, a 12Km wide lava field. From here we can hike to Chico Volcano to watch the striking lava formations, examples of the geological occurrences that have created the Galapagos Islands.



Punta Moreno

Punta Moreno is located on the north coast of Isabela Island between the volcano Sierra Negra and Cerro Azul volcano. The trail runs along a lava flow Pahohoe (solidified lava in the form of corrugated iron or an accordion) into a complex of coastal lagoons. Its main attraction are several species of birds which can be found around the lakes and mangroves.



Elizabeth Bay

This is a marine visitor site, the excursion is carried out in a zodiac and so there is no landing point. Your zodiac ride starts with a visit to the Marielas islets where there is the largest and most important penguin colony in the Galapagos Islands. The excursion continues into the cove that is surrounded by red mangroves where you can admire their red roots and green leaves. It is here that you are able to observe sea turtles, flightless cormorants, spotted eagle rays, golden rays, brown pelicans and sea lions. Frequently visitors have been able to see Galapagos hawks soaring overhead while schools of pompano and dorado fish swim below.



Urbina Bay

South from Tagus Cove and still on the west coast is Urbina Bay. It is an easy wet landing on a gentle sloping beach. This area is very interesting in that it is a perfect example of the geological activity of the islands. The waters of the bay are a good place to see turtles and rays and ashore is a short trail leading to a coral reef, which is evidence of an uplift from the sea which occurred in 1954.

From here it is easy to reach the Alcedo and Darwin volcanoes. You can see large colored land iguanas here and the possibility of seeing giant Galapagos turtles, flightless cormorants, blue-footed boobies, Galapagos penguins, pelicans and marine iguanas are excellent.

Tagus Cove

Tagus Cove, a tour along the cliffs in a zodiac will give the visitors a good chance to see the Galapagos penguin, the flightless cormorant and other sea birds. From the landing dock it is about a 30 minute hike along the trail up to the top of the cliff from where you can view Darwin Lake, an uplifted ultra saline lake saltier than the sea. You can also see several volcanoes from this location. Look carefully at the graffiti on the surrounding cliffs of the cove, it has been written by pirates, whalers and buccaneers in past centuries.



Espinoza Point

Fernandina is the third largest island in the archipelago and has a single visitor site: Punta Espinoza located at the northeastern tip of the island. Just across is Tagus Cove, a visitor site where some of the unique species of Galapagos can be seen. Marine iguanas conglomerate here in larger groups than on any other island. They bask on the sand, swim near the shore and sometimes block the way at the landing dock. Among the unique species found here is the flightless comorant. A bird that due to the lack of predators had to adjust their way of survival and perfect their skills of finding food in the ocean. Their wings, tails and feet progressively adapted for swimming. To see these birds is to witness evolution happening right in front of you.



Vicente Roca Point

Located at the 'mouth' of the head of the sea horse, which forms the northern part of the Galapagos Islands, is Punta Vicente Roca. Here are the remnants of an ancient volcano form two turquoise coves with a bay well protected from the ocean swells. The spot is a popular anchorage from which to take panga rides along the cliff that are the remains of the volcano or explore a partially sunken cave at the waters edge. Masked and blue-footed boobies sit perched along the point and the sheer cliffs, while flightless cormorants inhabit the shoreline.

The upwelling of coldwater currents in this part of the Galapagos, give rise to an abundance of marine life which, in combination with the protection of the coves, make Punta Vicente Roca one of the archipelago's most sought after dive spots.

One cove is only accessible from the sea by way of an underwater passage. The passage opens to calm waters of the hidden cove where sea lions like to laze on the beach having traveled along the underwater route. The entire area of Punta Vicente Roca lies on the flank of 2,600 foot Volcano Ecuador. This is the Galapagos Island's sixth largest volcano.

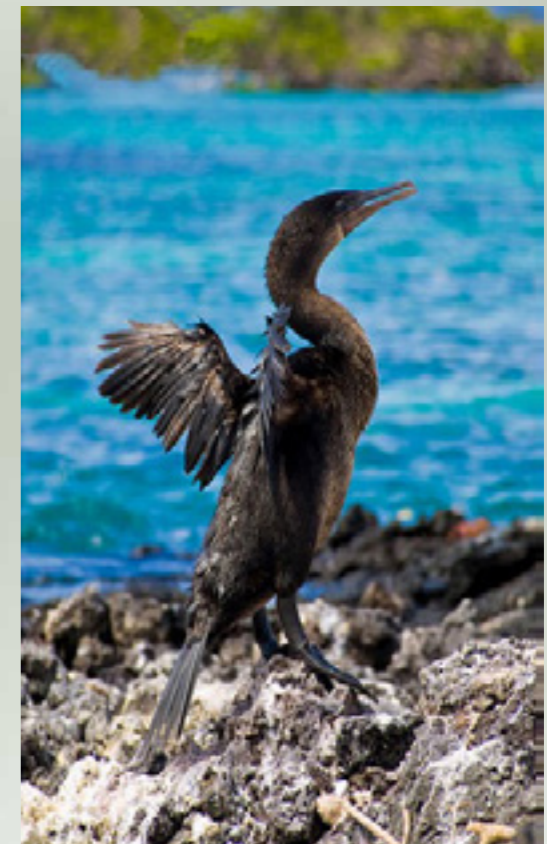

Activities

Snorkeling: This is a unique opportunity to experience the wonders of the Galapagos marine reserve like sea lions, sharks, turtles, penguins and marine iguanas flopping around the water.

Scuba Diving: Galapagos is one of the top diving spots in the world! With any immersion you may have the opportunity to see large pelagic fish, manta rays, stingrays, eagle rays, turtles, morays, hammerhead sharks and much more! You'll have the opportunity to dive on one or two days during your cruise. More details about this activity and the dive sites can be given on request.

Hiking: Guided hikes will give you an amazing opportunity to get up close with nature. Moreover you will enjoy the truly spectacular landscapes of different geological formations.

Wildlife Observation and Bird Watching: The encounter with the unique and fearless animals at very short distances is absolutely one of the most fascinating aspects of your visit to the Galapagos Archipelago. Moreover the Galapagos Islands are a real bird watcher's dream: 29 of the 58 resident bird species are endemic, such as the Darwin finches, the flightless cormorant, the red footed booby amongst others.





GALAPAGOS G R A N D ODYSSEY

Tips & Hints

What to bring to the Galapagos!

- * Clothing
- * Comfortable walking shoes
- * Sandals with thongs or Tevas for wet landings
- * Light cotton socks
- * Long-sleeved cotton shirts and T-shirts
- * Light cotton scarf to protect your neck
- * Shorts
- * Lightweight long pants or skirt / dress
- * Light rain jacket or wind breaker
- * Sweatshirt, Sweater, light jacket
- * Wide-brim hat
- * Bathing suits



Equipment

- * Sun block lotion
- * PABA sunscreen (at least # 15) - take lots, you will run out. The sun is very very hot here.
- * Lip salve
- * Sunglasses with a strap
- * Extra eye glasses/ contact lenses
- * Insect repellent, this is essential!
- * Personal medication
- * Self-sealing bags for electronic equipment
- * Camera - and SLR is perfect to use here
- * Underwater cameras to take photos of the animal life while snorkeling (take a few you will use them fast!)
- * Camera gear
- * Film and more film or enough flash memory to download pictures / memory cards, don't underestimate how many photos you will take, some people come back with over 2000 in 4 days!
- * Binoculars in case you want to get a more detailed look at unique animals in Galapagos.
- * Extra batteries for cameras



Tips & Hints

Money and Security

- * Passport
- * Copy of passport
- * US Cash mostly low denomination bills (\$5 to \$20)
- * \$100 entrance fee is required in cash on arrival in Galapagos
- * Travel Insurance
- * Motion Sickness pills
- * Salted Crackers
- * Candied Ginger or ginger tablets
- * Patch / wrist bands
- * Plastic Bags



First Aid

- * Pepto Bismol or Kaopectate for stomach upset and mild diarrhea.
- * Immodium or Lomotil for more severe diarrhea
- * Band - Aids
- * Anti-biotic cream
- * Aloe Vera cream or gel for sunburn
- * Tylenol or other mild pain relief



GALAPAGOS
G R A N D
ODYSSEY

BOOKING PROCEDURE:

- 1) Cruise booking:** The first thing to book is the Galapagos cruise in order to secure availability. Since there are fixed departure dates for every boat you can build your land program around the cruise itinerary.
- 2) Domestic flights:** From mainland Ecuador to the Galapagos Islands and back. Space is guaranteed with your cruise booking (price depends on route).
- 3) Airport transfers:** 4 are necessary. 1 for your international arrival, 2 for the transfer out for the flight to Galapagos, 3 transfer in from your return flight from Galapagos and 4 transfers out for your international flight home.

WHAT TO DO:

Consult **availability** before confirming your Galapagos Cruise. We will advise you on spaces available and if spaces are not available we can recommend alternative dates or boats.

Once we receive your space block via email we will add a **time limit** to it, 1 week to start. This can be extended by request. During this time period you have no obligation nor will you incur any cancellation fees.

Upon confirmation of spaces you have **1 week to secure spaces with a deposit**. This deposit can be done by wire transfer to our bank account in the U.S. or by mailing a check to our bank in New Jersey (USA). Bank information will be provided to you by your sales representative. Another option is to pay is by paypal.

Your **full payment** for the cruise spaces is needed at least 60 days prior to your cruise departure date. Please note that if we do not receive the full payment 60 days before the departure date we reserve the right to release your cruise spaces and sell them to the next person on our waiting list.

Once you have made your first deposit, we need a photocopy of the passenger passport and will need to know the travel information (inbound flights to Ecuador, hotel reservations and itinerary). The passport copy is mandatory in order to confirm flights to the Galapagos Islands; it is also requirement for your Galapagos Islands immigration card. At least 30 days before the departure it is very important that you let us know: dietary restrictions, allergies, medical conditions, special arrangements and as much information as possible about the client so that we can help make their trip memorable.

IMPORTANT: We require that your passengers book their Galapagos flights with us. This is to make sure they are on the same flight as the rest of the people travelling on the boat. We cannot wait for passengers who arrive on a later flight, the boat will depart with the passengers that arrive with our airline allotment or who are at the airport at this time (in case they have arrived in the Islands in advance). This should also be taken into account when making the international flight arrangements. If the international flight is cancelled or delayed and they do not make it on time, the yacht will not wait. We recommend arriving in Quito or Guayaquil at least 2 days before the Galapagos cruise date, plus there is plenty to do in either city. We are not liable and will not offer any refunds under any circumstances for missed flights and for passengers who do not arrive on time at the airport in the Galapagos Islands. We will deliver you a print out of the e-ticket upon arrival in Ecuador

DEPOSIT, PAYMENT & CANCELLATION PROCEDURES

GALÁPAGOS CRUISES & LAND

GALÁPAGOS CRUISES:

- * To confirm your booking: 20% Deposit
- * 60 days prior to departure (Fits), 90 days (Charter): 80% Full Payment

CANCELLATIONS AND PENALIZATIONS

- * From the time of booking until 121 days before the cruise the cancellation fee will be USD 3000 for charter bookings & USD 200 for FIT bookings
- * From 121 - 61 days prior to departure there is a 20% Penalty.
- * From 60 - 00 days (FITS), 90 days (Charter) there is a 100% Penalty.

LAND SERVICES

To confirm your booking: 30% Deposit
60 days prior to departure (Fits): 70% Full Payment

CANCELLATIONS AND PENALIZATIONS

From the time of booking until 1 Month before tour start no cancellation fee will be charged. 30-00 days before tour start there is a 100 % penalty. Please be aware of special cancellation fees for Amazon Lodges and exclusive accommodation e.g. Galápagos Hotels.

Important Notes:

- a) LATIN TRAILS reserves the right to release spaces if payment is not received according to schedule.
- b) LATIN TRAILS will only accept written cancellations.
- c) Penalties for cancellations will be automatically discounted from deposits.

* From 60 - 00 days (FITS), 90 days (Charter) there is a 100% Penalty.

Contact Us:

Skype: [ecuadorboutiquetravel](https://www.skype.com/name/ecuadorboutiquetravel)
mail: reservations@latintrails.com

Phone: (593-2) 2867832 / 2867377
Toll Free from USA & Canada 1800 747 0567

<http://www.latintrails.com/>
<http://www.latintrails.com/grand-odyssey>
<http://www.galapagosgrandodyssey.com/>

Address: Isla Española #144, between Av. General Rumiñahui and Av. Ilalo. San Rafael.
Quito – Ecuador